

3/2 WAY DIRECT ACTING SOLENOID VALVE

(Normally Close)

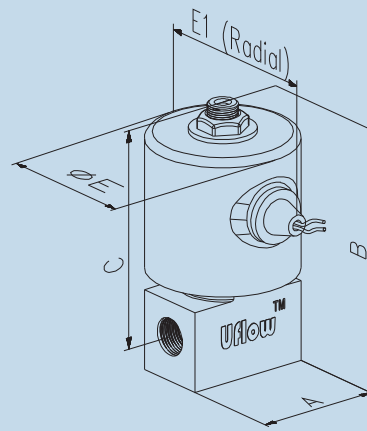
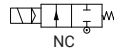

Diagram No. 18.1



SPECIFICATIONS

Port :	Refer below technical data sheet (Available BSP / NPT)				
End Connection :	Screwed				
Body Material :	SS ASTM A351 Grade CF8 / CF8M, Forged Brass, Aluminium				
Seal & 'O' Ring	Nitrile (NBR)	EPDM	Viton (FKM)	PTFE	
Media Temp :	-30° C to 90° C	-10° C to 140° C	-10° C to 180° C	-10° C to 180° C	
Circumstance Temp :	-10° C to 70° C				
Media :	Air, Water, Chemical, Gas, Oil, Diesel, Kerosene, LPG.				
Main Features :	Internal Parts are in superior corrosion resistance steel, (Equivalent to SS316L) Suitable for Food Industries, Pharmaceuticals, Chemical application & Highly corrosive environment.				
Operating Voltage :	24AC	110AC	230AC	12DC	24DC
Power Consumption :	7W	8W	8W	10W	11W
Coil Features :	High Reliability Unaffected by Voltage Surges. Easy coil changes coil lockable in 4X90 position or freely movable in between as require.				
Coil Housing :	Epoxy square coil, Metallic round enclosure, IP-67 Flameproof enclosure, IP-68 Weatherproof enclosure.				
Optional Feature :	90% Power saver series also available.				
Other Specification Data :	Available on Request.				

NOTE: Use of filter in the inlet port is recommended.

DIMENSION

All dimensions are in mm

Model No.	Port Size	Diagram No.	A	B	C	E	E1
TAN14	¼"	18.1	44.50	87	77	44	57
TBN14	¼"	18.1	43	89	80	44	57
TCN14	¼"	18.1	43	88	79	44	57
TBN74	⅜"	18.1	48	93	80	44	57
TBN24	½"	18.1	48	93	80	44	57
TCN24	½"	18.1	48	93	80	44	57
TBN040	⅝"	18.1	38	60	51	28	33
TBN140	¼"	18.1	38	60	51	28	33
TBN034	⅝"	18.1	16	50	43	21	51

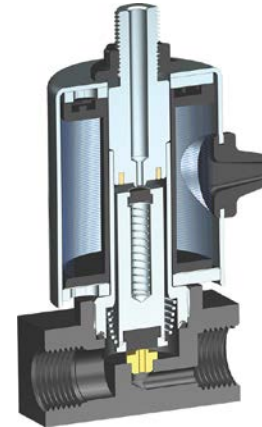

SECTION VIEW

TECHNICAL DATA

Model No.	Body Material	Pipe (Inch)	Orifice (mm)	Min. Operating Pressure Kg/cm ²	Max. Operating Pressure Kg/cm ²	Seal & 'O' Ring Material	Flow Factor Kv m ³ / hr
TAN14	ALUMINUM	¼"	1.50	0	10	NBR / SI / FKM /EPDM	0.07
TBN14	BRASS	¼"	1.50	0	10	NBR / SI / FKM /EPDM	0.07
TCN14	CF8 / CF8M	¼"	1.50	0	10	NBR / SI / FKM /EPDM	0.07
TBN74	BRASS	⅜"	1.50	0	10	NBR / SI / FKM /EPDM	0.07
TBN24	BRASS	½"	1.50	0	10	NBR / SI / FKM /EPDM	0.07
TCN24	CF8 / CF8M	½"	1.50	0	10	NBR / SI / FKM /EPDM	0.07
TBN040	BRASS	⅝"	1.20	0	10	NBR / SI / FKM /EPDM	0.042
TBN140	BRASS	¼"	1.20	0	10	NBR / SI / FKM /EPDM	0.042
TBN043	BRASS	⅝"	1.20	0	7	NBR / SI / FKM /EPDM	0.042